



CENTRAL MACHINE SHOP



prototype to production

www.centrmachineshop.com

(276) 669-2816



CENTRAL MACHINE SHOP

Contact Info

14773 Wallace Pike
Abingdon, VA 24203

Phone (276) 669-2816
fax: (276) 669-2143

www.centrmachineshop.com

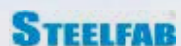



**Prototype
to Production**

About Central Machine Shop

Central Machine Shop started in 1975 with 2 men and 2250 square feet. Eight building additions later, we are still committed to what we were then: outstanding quality, superior service, and turnaround times that get you back to work. Our team of skilled machinists has a combined 300 years of experience in this industry.

At Central Machine Shop, our goal is to ensure your manufacturing process is smooth and successful. Whether it's supply chain management, contract manufacturing, or your worst nightmare-emergency repairs, let us be the shop you call.

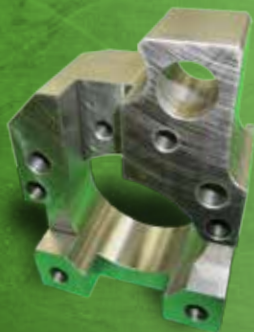

Contract Manufacturing

Central Machine Shop can work with you to manufacture the custom parts you need for your operation. We work with you to meet your specifications and deadlines. The experienced team offers specialized service, and our quality control means you have a strong business partner who can save you time and money. We can even warehouse product to anticipate future needs, while saving you space.

Emergency Repairs

When your production line is down, make Central Machine Shop your first call. Our specialized service for emergency repairs can get you back to business. We offer 24-hour service to get your line up and running again. We have an inventory of raw materials, including stainless steel, cast materials, tool steels, aluminum, brass, bronze and plastics so we can begin immediately.

Supply Chain Partnership

CMS wants to be your first choice as a supply chain partner. We can provide the materials you need, fabricated and delivered on time to keep your process optimized. We have the capability and experience to ensure you have what you need when you need it.



CNC MACHINING

- 1 - Mazak VQC-20/50B, Table Size 21"x48" (X/Y/Z) 39"x20"x18"
- 1 - Mazak V-10, Table Size 45"x19" (X/Y/Z) 30"x19"x20"
- 1 - Mazak Nexus 510C Table Size, 51"x21". (X/Y/Z) 41"x20"x 20"
- 1 - Mazak H500/50 Horizontal, 2 Pallets 19.7"x19.7" (X/Y/Z) 28"x25"x25"

CNC TURNING

- 1 - Mazak M-4 20x60 (22" Swing, 60" Centers)
- 1 - Mazak Quick Turn 10 (Swing 17", 20" Centers)
- 1 - Mazak Quick Turn 20 (Swing 20", 38.8" Centers)
- 1 - Mazak Quick Turn 20N (Swing 20"x38.8" Centers)
- 1 - Mazak Quick Turn Smart 350 (Swing 16"x48" Centers)
- 1 - Mazak Nexus 300 (Swing 16"x48" Centers)

ENGINE LATHES

- 1 - Mazak 18"x24"
- 1 - Kingston 20"x100"
- 2 - Clausing Colchester 15"x50"

GRINDERS

- 1 - Thompson surface grinder 14"x60"
- 1 - Delta tool & cutting grinder
- 1 - Superior Hone



HEAT TREATING

- 1 - K.H. Huppert furnace 6"x6" x8"
- 1 - Cress furnace 12" x 12" x 10"
- 1 - Cress furnace 12" x 12" x 40"
- 1 - Rockwell hardness tester

MILLS

- 1 - Greaves Cincinnati Horizontal
- 1 - Cincinnati Vertical
- 1 - Van Norman

OTHER SYSTEMS

- 1 - Brown & Sharpe System 2000 coordinate measuring machine
- 1 - 4 spindle Buffalo drill press
- 1 - Howe & Fant turret drilling machine
- 1 - Powermatic drill press
- 2 - 15" drill presses
- 1 - Leland Gifford 6 spindle drill press
- 1 - Morrison 1 1/4" keyseater
- 1 - Atlas press
- 1 - Drake 50 ton press
- 1 - Kodak contour projector

SAWS

- 1 - Do All automatic saw (10" capacity)
- 1 - Kysor-Johnson vertical band saw
- 2 - Wells cut-off band saws

WELDERS

- 1 - Miller Dialarc welder (tig/arc)
- 1 - Miller Deltaweld with wire feed (mig)
- 1 - Airco Dip Core with wire feed (mig)